



## Carleton Road

Tufnell Park Islington N7 0QZ

£599,500

In need of full refurbishment, a particularly spacious two bedroom, share of freehold flat occupying the lower ground floor of a substantial detached Victorian villa, well situated in the southern section of Carleton Rd, within easy walking distance of Tufnell Park Underground.

Offering 900 square feet of accommodation, the property is bright and spacious, all rooms being of a good size and with good levels of light throughout.

To the rear is a very good size, mature communal garden.

Carleton Rd is a popular residential location in the heart of leafy Tufnell Park, well placed for a range of shops, schools, leisure and transport amenities, the nearest Underground station being at Tufnell Park (Northern Line).

- Two bedroom flat
- Attractive detached period building
- In need of full refurbishment
- 900 square feet
- Mature communal garden
- Share of freehold

### Viewing

Please contact our Kentish Town Sales Office on 0207 482 4488 if you wish to arrange a viewing appointment for this property or require further information.



2



1



1





Floor Plan

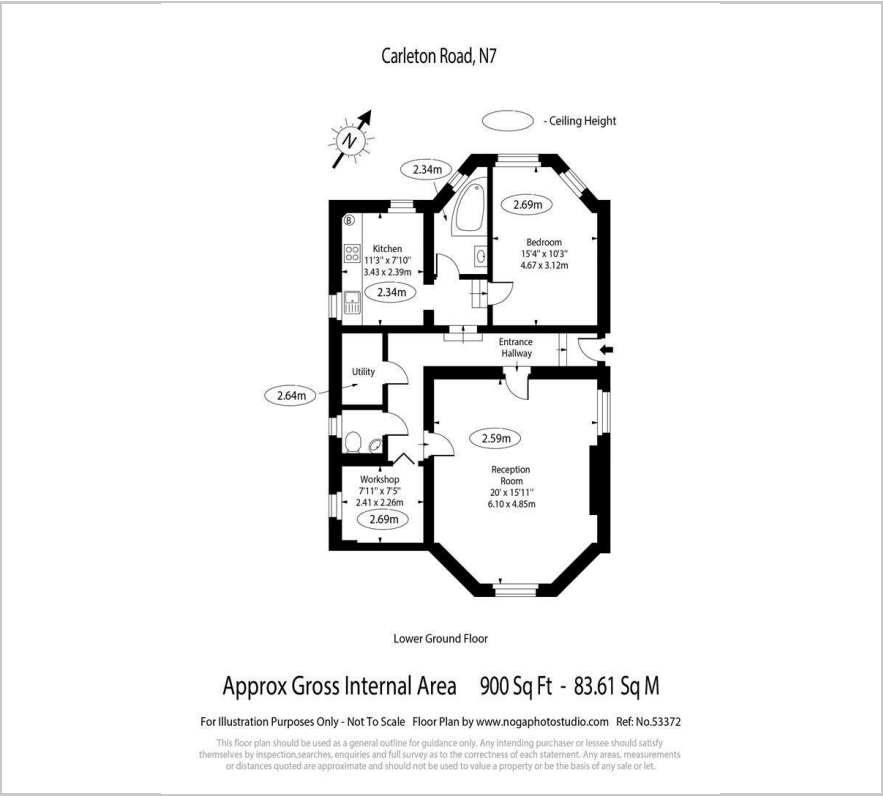

Area Map

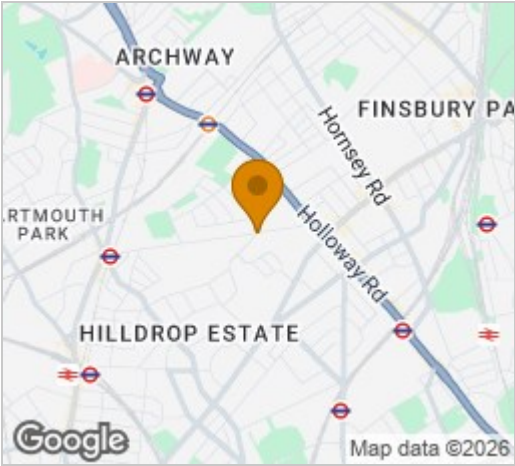

Energy Efficiency Graph



These particulars, whilst believed to be accurate are set out as a general outline only for guidance and do not constitute any part of an offer or contract. Intending purchasers should not rely on them as statements of representation of fact, but must satisfy themselves by inspection or otherwise as to their accuracy. No person in this firm's employment has the authority to make or give any representation or warranty in respect of the property.